

*Viewshed Analysis*  
*Proposed Verizon Wireless*  
*Telecommunications Facility*  
*East Woodstock - Alternate Site*  
*445 Prospect Street*  
*Woodstock, Connecticut*

**NOTE:**

- Viewshed analysis conducted using ESRI's Spatial Analyst.
- Proposed Facility height at alternate location is 150 feet.
- Existing tree canopy height estimated at 65 feet.
- Study Area is comprised of a two-mile radius surrounding the proposed facility and includes 8,042 acres of land.

**DATA SOURCES:**

- Digital elevation model (DEM) derived from Connecticut LiDAR-based Digital Elevation Data (collected in 2000) with a 10-foot spatial resolution produced by the University of Connecticut and the Center for Land Use Education and Research (CLEAR); 2007
- Forest areas derived from 2006 digital orthophotos with 1-foot pixel resolution; digitized by VHB, 2010
- Base map comprised of Eastford (1983), Putnam (1970), Southbridge (1979) and Webster (1979) USGS Quadrangle Maps
- Municipal and Private Open Space data layer provided by CT DEP, 1997
- Federal Open Space data layer provided by CT DEP, 2004
- CT DEP Property data layer provided by CT DEP, Dec 2009
- CT DEP boat launches data layer provided by CT DEP, Dec 2009
- Scenic Roads layer derived from available State and Local listings

Map Compiled April, 2010

**Legend**

- Alternate Tower Site Location (Includes select areas of visibility approximately 500 feet around facility)
- Balloon is not visible
- Balloon visible above trees
- Year-Round Visibility (Approximately 235 acres)
- Approximate Seasonal Visibility (Approximately 99 acres)
- Protected Municipal and Private Open Space (CT DEP, 1997)
- Preservation
- Conservation
- Existing Preserved Open Space
- Recreation
- General Recreation
- School
- Uncategorized
- CT DEP Property (CT DEP, Dec 2009)
- State Forest
- State Park
- DEP Owned Waterbody
- State Park Scenic Reserve
- Historic Preserve
- Natural Area Preserve
- Fish Hatchery
- Flood Control
- Other
- State Park Trail
- Water Access
- Wildlife Area
- Wildlife Sanctuary
- Federal Open Space (CT DEP, 2004)
- Boat Launches (CT DEP, Dec 2009)
- Historic Resource
- Gosnell Preserve
- Scenic Road (State and Local)
- Town Line

**Inset Map**  
**Town of Woodstock**

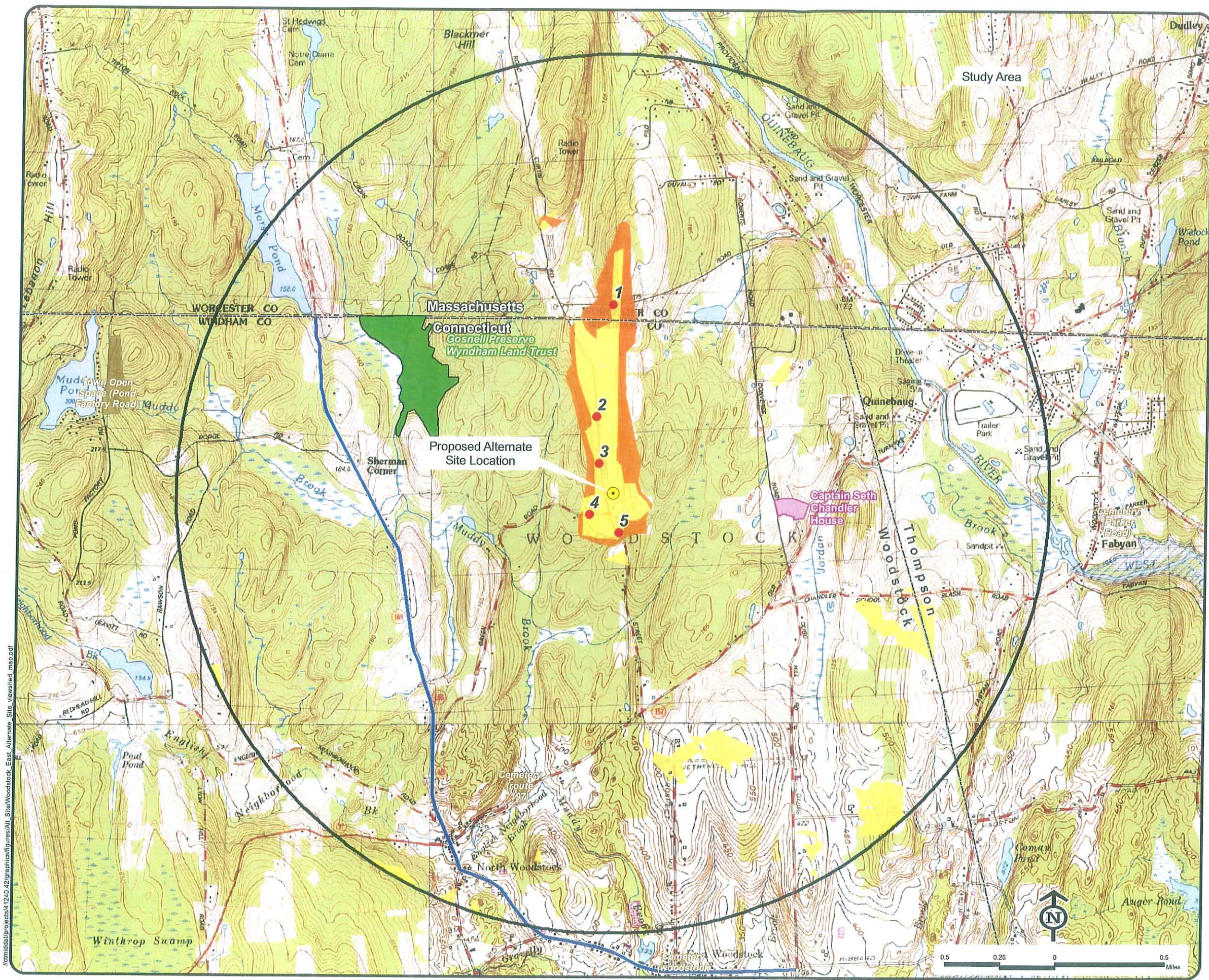
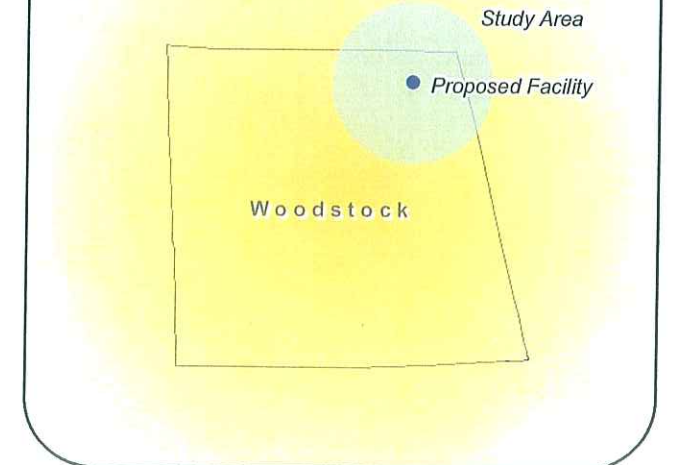

I:\cmdata\projects\1240\_42\graphics\figures\Alt\_Site\Woodstock-East-Alternate\_Site\_viewshed\_map.pdf