

# GENERATOR SUMMARY REPORT

1/1/1984 thru 12/31/2008

Generator EPA ID: CTP000008960

Generator Name & Site Address CULBRO TOBACCO

45 HOSKINS RD

SIMSBURY, CT, 06070 USA

Mailing Address:

45 HOSKINS RD

SIMSBURY, CT, 06070 USA

MANIFEST	DTSHIPPED	US DOT DESC	HAZ CL	# OF CONT	CONT TYPE	QTY	WT/VO	EPA CODE	BATCH#
CTC0190868	2/17/1989	WASTE LIQ NOS GAS/WATER	FLAM	001	TT	50	G	D001	999999

# GENERATOR SUMMARY REPORT

1/1/1984 thru 12/31/2008

Generator EPA ID: CTP000010194

Generator Name & Site Address CULBRO CORP

HOSKINS RD

SIMSBURY, CT, 06070 USA

Mailing Address:

HOSKINS RD

SIMSBURY, CT, 06070 USA

MANIFEST	DTSHIPPED	US DOT DESC	HAZ CL	# OF CONT	CONT TYPE	QTY	WT/VO	EPA CODE	BATCH#
INA0358920	1/15/1990	HAZARDOUS WASTE SOLID, NOS	ORM-E	001	CM	20	Y	D004	999999
INA0358917	1/22/1990	HAZARDOUS WASTE SOLID, NOS	ORM-E	001	DT	25	Y	D004	999999
INA0358919	4/24/1990	HAZARDOUS WASTE SOLID, NOS	ORM-E	001	CM	20	Y	D004	
INA0460300	6/20/1990	HAZARDOUS WASTE SOLID, NOS	ORM-E	001	DT	18	Y	D004	999999
RIS0017082	3/4/1998	corrosive liquid nos	8	001	TT	1966	G	D002	1193 1216

**UNDERGROUND STORAGE FACILITY NOTIFICATION**



STATE OF CONNECTICUT  
Department of Environmental Protection  
UNDERGROUND STORAGE FACILITIES PROGRAM  
HAZARDOUS MATERIALS MANAGEMENT UNIT  
165 Capitol Avenue, Hartford, CT 06106  
TEL. 555-4630



EPHA-6 NEW 10/83

2 of 2

1.  FIRST NOTIFICATION OR  SUBSEQUENT NOTIFICATION (If checked, enter No.)

2. SITE ID: 0528

3. FOR STATE AGENCY USE ONLY  
A. DATE RECD BY DEP: 11-28-89  
B. DATE ENTERED: 11-28-89  
C. DATE ENTERED:   
D. GRID COORDINATES:   
E. DOES FACILITY MEET NEW REQUIREMENTS?  YES  NO

PLEASE TYPE: ALL THREE COPIES MUST BE LEGIBLE!  
REFER TO INSTRUCTIONS FOR FILING NOTIFICATION BEFORE COMPLETING FORM.

4. LOCATION: SITE NAME: Farm #2  
BUSINESS NAME AND ADDRESS: Culbro Tobacco  
Culbro Corporation  
387 Park Avenue South  
PO Box 480  
Simsbury  
Bloomfield  
New York

5. NO. AND STREET: 45 Hoskins Road  
6. NO. AND STREET: 387 Park Avenue South  
7. NO. AND STREET: PO Box 480  
8. TYPE OF OWNER:  PRIVATE  STATE  MUNICIPAL  FEDERAL (G.S.A. No. \_\_\_\_\_)

9. OPERATOR/CONTACT PERSON: R. T. Milliken  
10. NO. AND STREET: 1600 Prospect Hill Road  
11. CITY OR TOWN: Windsor, CT  
12. STATE: CT  
13. ZIP CODE: 06095  
14. TELEPHONE: (203) 243-2561

10. TANK ID	11a. DATE OF INSTALLATION (Mo./Yr.)	11b. LIFE EXPECTANCY (in years)	12a. TOTAL CAPACITY (Gals.)	12b. STATUS	13. DATE TANK LAST USED (Mo./Yr.)	13. TYPE OF CONTENTS	14. CHEMICAL NAME OF PRINCIPAL SUBSTANCE (not trade name.) (Enter C.A.S. No., if known)	15. CONSTRUCTION MATERIALS			16. PROTECTION			17. INTEGRAL PIPING SYSTEM		18. MONITORING SYSTEM (Specify type from list B)	19. FAILURE DETERMINATION (If "YES", enter DATE and attach results. If "NO", enter "NO")
								STEEL	FIBERGLASS REINFORCED PLASTIC	OTHER (Specify from list A)	LINED	UNLINED	INTERNAL	EXTERNAL	OTHER (Specify from list B)		
Example	5/75	30	5000	X		X	Heating fuel #2	X	X	X	X	H	5	5/75	U	NO	
Example	7/60	-	8000	X	8/78	X	1,1,1-Trichloroethane CAS #79016	X	X	X	X	H	7	7/60	U	-	
F261	??		3,000		2/89	X	Gasoline	X	X	X	X	H	7	?	U	No	
F26R1	2/89	20	4,000	X		X	Gasoline	X	X	X	X	H	3	2/89	A,C,D,	No	

20. HAVE YOU ATTACHED SKETCH OF TANKS AND LOCATION?  YES  NO

21. COMMENTS:

22. CERTIFICATION: I certify under penalty of law that I have personally examined and am familiar with the information submitted in this and all attached documents and that based on my inquiry of those individuals immediately responsible for obtaining the information, I believe that the submitted information is true, accurate, and complete. Penalties: any person who knowingly fails to notify shall be subject to a civil penalty not to exceed \$10,000 for each tank for which notification is not given or for which false information is submitted.

22a. SIGNATURE: R. T. Milliken  
22b. DATE SIGNED: 7/14/89  
22c. NAME (Type or Print): R. T. Milliken  
22d. OFFICIAL TITLE (of owner or authorized representative): President

SECTION C

SECTION B

SECTION A

COPY 1: SEND TO DEP: 166 CAPITOL AVE. HARTFORD, CT 06106

(5)

9B

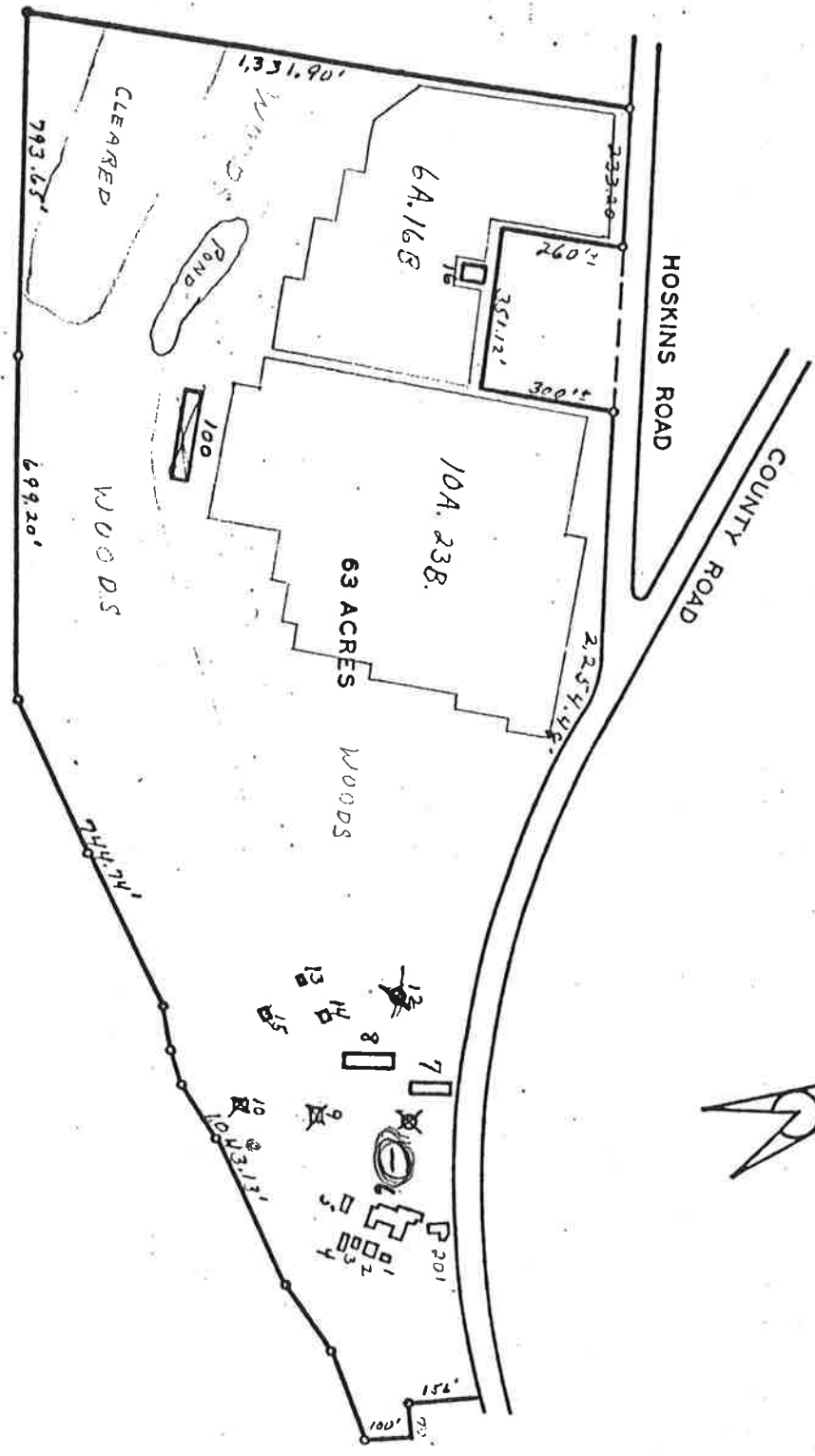

Farm #2

HOSKINS LOT  
 HOSKINS ROAD S.  
 SIMSBURY, CONN.  
 DATE: FEB. 1963 SCALE: 1" = 400'  
 REDRAWN: OCT. 15, 1967